

# 800 Comanche Rd NE

Albuquerque, NM

## BUILDING SIZE

58,738 ± SF

## AVAILABLE SPACE

16,172 ± SF

Showroom / Retail – 6,974 ± SF

Shop / Warehouse – 5,105 ± SF

Office – 4,093 ± SF

## LEASE RATE

\$5.50 / SF / YR

NNN Lease

## ZONING

M-1 (City of Albuquerque)

## FEATURES:

- ✓ Easy access to I-25 at Comanche Rd Exit
- ✓ Fronts onto Comanche Rd
- ✓ 17' to 17'10" clear ceiling heights
- ✓ Sprinkler System
- ✓ 3 Phase power
- ✓ 3 Dock high loading doors

## For Additional Information Contact

### David Oberstein

O: 505-986-0700 Ext 11

C: 505-470-2345

david@obersteinproperties.com



# 800-806 COMANCHE ROAD NE

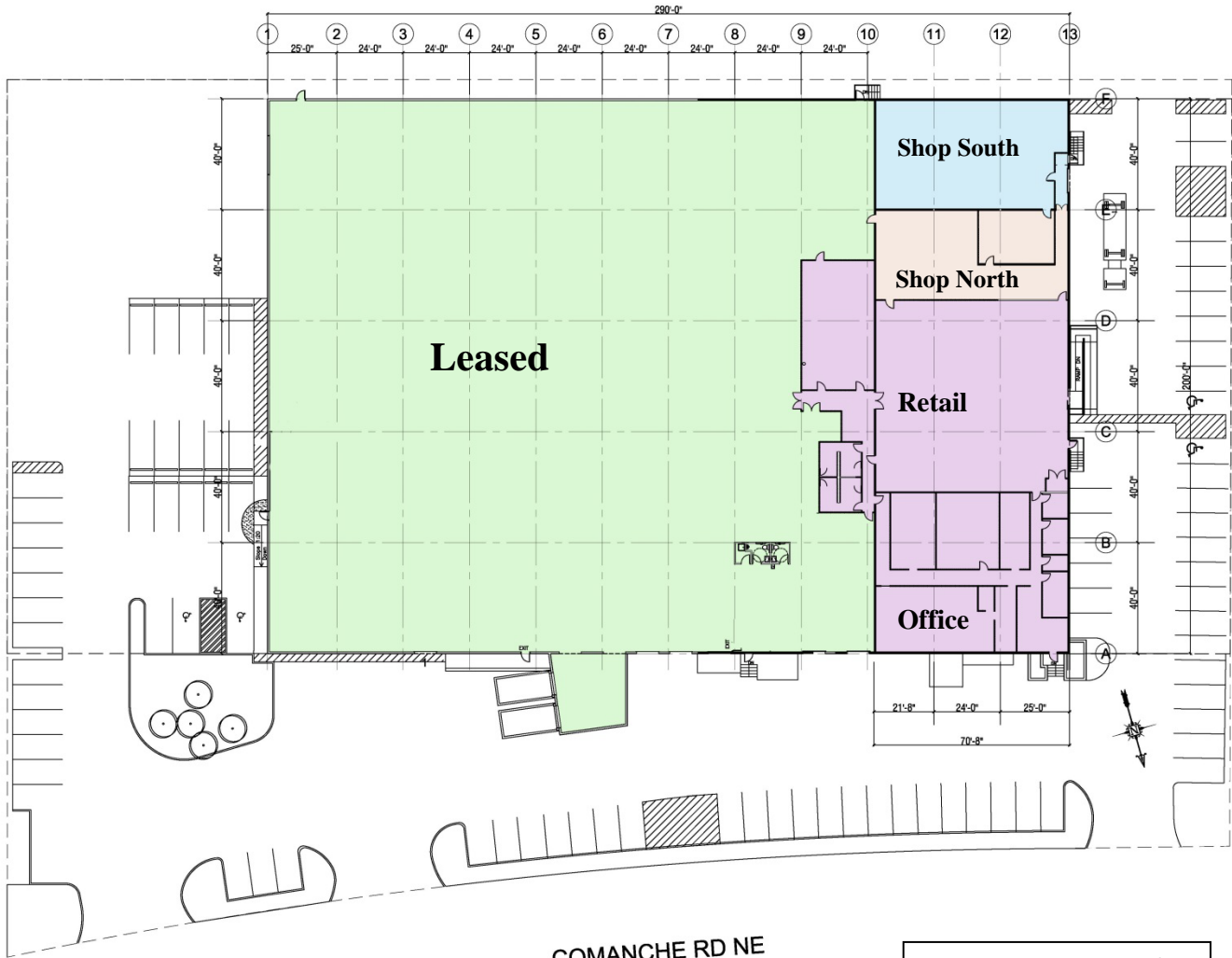

COMANCHE RD NE

### **SQUARE FOOTAGES (+/-)**

Retail / Office – 11,067  
 Shop North – 2,290  
 Shop South – 2,815  
 Total Available – 16,172  
 Total Building – 58,738

MAIL P.O. Box 1477, Santa Fe, NM 87504-1477  
 PHONE (505) 986-0700 CELL (505) 470-2345

DELIVERY 215 Lincoln Avenue, Santa Fe, NM 87501  
 EMAIL david@obersteinproperties.com



**Comanche Road Frontage**



**West Elevation**



**Retail / Showroom**

MAIL P.O. Box 1477, Santa Fe, NM 87504-1477  
PHONE (505) 986-0700 CELL (505) 470-2345

DELIVERY 215 Lincoln Avenue, Santa Fe, NM 87501  
EMAIL [david@obersteinproperties.com](mailto:david@obersteinproperties.com)